

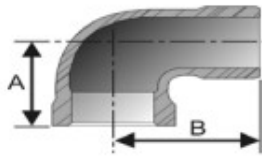

MSI Malleable Iron Pipe Fitting Specifications

800-678-2544 phone 800-678-0857 fax www.msi-products.com msisales@msi-products.com
 THREADS: ANSI/ASME B1.20.1 DIMENSIONS: ANSIB16.3 MATERIAL :ASTM A197

300lb. 90° Street Elbows



Size	Inner Carton	Master Case	"A" Inch	"B" Inch	Black Item Number	Galv. Item Number	Approx. Wgt. Ea / lbs.
1/4"	180	360	0.94	1.44	A2910664	A7210604	0.172
3/8"	120	240	1.06	1.63	A2910666	A7210606	0.258
1/2"	40	80	1.25	1.99	A2910668	A7210608	0.390
3/4"	30	60	1.44	2.19	A2910612	A7210612	0.628
1"	20	40	1.63	2.56	A2910616	A7210616	1.021
1 1/4"	12	24	1.94	2.87	A2910620	A7210620	1.678
1 1/2"	8	16	2.13	3.13	A2910624	A7210624	1.726
2"	6	12	2.49	3.69	A2910632	A7210632	3.633
2 1/2"	2	4	2.89	4.02	A2910640	A7210640	3.907
3"	1	2	3.35	4.72	A2910648	A7210648	7.438
4"	1	2	4.13	5.83	A2910664	A7210664	10.496